

Thank you for choosing quality Scott Drake products for your vehicle. Please refer to the installation instructions below when installing this part.

**WARNING: Always wear protective eye-wear when working on your vehicle. Disconnect the battery. If any part of this installation seems beyond your level of experience, please seek the help of a professional installer.**

### INSTALLATION:

1. Remove existing antenna by disconnecting antenna socket from radio and removing cable from any fasteners, clips, etc. that may be in place. Make sure antenna mast is fully extended and remove antenna nut while holding on to antenna mast. Allow antenna assembly to rest in bottom of area between fender and inner fender. Remove antenna base. Pull up on antenna assembly, working it out of the antenna hole and pull out the antenna lead. Save the wedge (#5 in diagram) for reuse in the new billet antenna assembly. If needed it can be purchased separately under P/N: C5ZZ-18A915-A.

2. If necessary, loosen thread cap (cap used to protect mast-threads) on new antenna assembly (1) to expose approximately 1/4 inch of thread. Loop strong twine, fishing line, etc. Around threads and tie a firm knot. Leave enough length to ensure other end of twine or line will not fall into antenna hole. This is to ensure antenna assembly does not end up in area between inner fender and fender with no easy means of retrieval.

3. Route antenna wire through antenna hole in fender and kick panel hole. Pull grommet (2) through hole until seated. Install antenna socket into radio (3), and reinstall any clips or fasteners (4) used in original installation.

4. Using twine attached to antenna assembly, lower assembly through antenna hole in fender low enough to install wedge (5) from original antenna. Install new rubber gasket (6) on billet base (7) and thread twine through base allowing it to sit over antenna hole where original base was seated. Pull twine or line until antenna assembly comes up through fender hole. Make sure wedge is properly clocked and seated on antenna assembly and in fender hole.

5. Thread new billet antenna nut (8) over base onto antenna body. Make sure locating notch on base is installed over tab on wedge. There are a few degrees of adjustment built into base to allow for variances in antenna hole slot location.

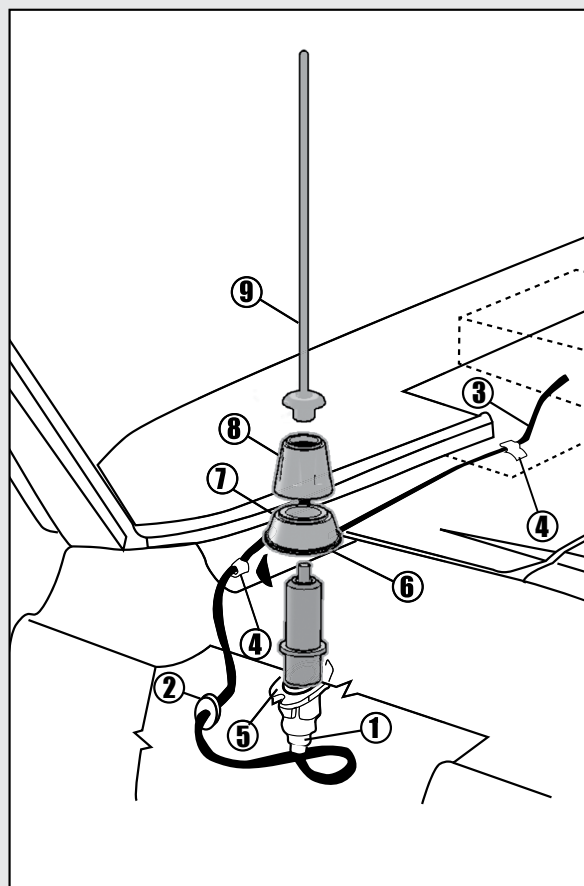

6.Remove string and thread cap from antenna assembly and finish tightening antenna nut until tight against fender.

7.Thread antenna mast (9) onto antenna assembly. Using pliers and a thick rag, strap wrench, or other suitable non marring means, tighten mast securely.

#### Also available from Scott Drake:



**LeMans Aluminum  
Gas Door**

**CSX-9030-A**

#### INSTALLATION:

If you are not happy with this product for any reason or found product to be defective in manufacturing, simply return it to Drake Automotive Group within 30 days of purchase and we will replace it - no questions asked. We stand behind our products one hundred percent, so you can sit behind the wheel with pride.

*\* Please call Drake Automotive Group Customer Service for a Return Authorization (RA) before returning any product. Proof of purchase and dated receipt must be present with any return. All returned products are tested and if found to be damaged by the installer, no replacement will be issued. You pay the cost to ship to us, we pay for the return shipping. Guarantee does not include any labor and/or tax charges incurred.*

#### Also available from Scott Drake:

##### Bullet Style Mirrors



**C5RZ-17696-AL**

##### Sidewinder™ Billet Tail Light Bezels



**B-13489-C**

To place an order, or for current pricing, call your authorized Scott Drake dealer.

For a list of dealers in your area, or for any other questions about Scott Drake products, visit [www.DrakeAutomotiveGroup.com](http://www.DrakeAutomotiveGroup.com) or call our customer service department toll free:

**1.800.999.0289**

Mon - Thurs 7:00 a.m. to 5:00 p.m.  
Friday 7:00 a.m. to 4:30 p.m. - PST



**130 Cassia Way  
Henderson, NV 89014**

**t: 702.853.2060  
f: 702.853.2062**